



UNMC | NEBRASKA MEDICINE

SITE FURNISHINGS DESIGN STANDARDS

olsson studio

Revision 1: March 2024

Olsson Project #: 021-03478

**Re: UNMC / Nebraska Medicine
Site Furnishings Design Standards - Revision 1**

March 2024

To whom it may concern,

The University of Nebraska Medical Center and Nebraska Medicine covers a significant portion of midtown Omaha, generally bounded by Dodge Street to the north, Leavenworth Street to the south, 48th Street to the west, and 38th Avenue to the east. The urban campus is both a landmark and an important part of the City of Omaha's healthcare and educational networks.

Future development efforts will expand the campus to the west across Saddle Creek Road. The proposed private/public partnership development will increase both indoor and outdoor spaces on campus, including the construction of the Innovation Hub, a new Administration Building Tower, and multiple future buildings. These projects may be led by different developers in conjunction with UNMC | Nebraska Medicine.

The campus expansion offers the opportunity to create an identity for the Saddle Creek Campus and streamline design selections through standardization. These design standards will ensure that the future campus, touched by multiple developers, will be cohesive, functional, and aesthetically pleasing. While these design standards have been created specifically for the new Saddle Creek Campus, they should also be utilized throughout the entire campus.

The intent of this document is to provide design direction on the site furnishings for developers and their design teams for current and future projects. This document outlines a range of exterior site furniture and fixtures grouped into categories. Olsson has created this document in conjunction with UNMC | Facilities. This document does not alleviate the designer's responsibility to comply with local codes and campus systems.

As campus continues to grow and evolve, the selections provided within this document may be revised. Verify the most recent version of this document is being utilized. If variation from these design standards are desired for a specific project, the developer and design teams should work with their designated UNMC | Nebraska Medicine project manager for approval.

Revision 1: Added fence/screen, updates to pedestrian lighting, parking lot lighting, bollard lighting, step lighting, up-lighting, and wall lighting.

Sincerely,



Kayla Meyer, PLA
Olsson Studio



Lucas Weatherly, PE
Olsson



Table of Contents

SITE FURNISHINGS

BENCHES.....6

PICNIC TABLES.....13

TABLE & CHAIRS.....16

RECEPTACLES.....21

BOLLARDS.....22

BIKE AMENITIES.....26

PLANTERS.....28

RAILINGS.....29

FENCES.....31

LIGHTING

PEDESTRIAN LIGHTING.....33

PARKING LOT LIGHTING.....34

BOLLARD LIGHTING.....35

STEP LIGHTING.....36

UP-LIGHTING.....37

WALL LIGHTING.....38

SIGNAGE LIGHTING.....39

APPENDIX

HANDRAILS.....41

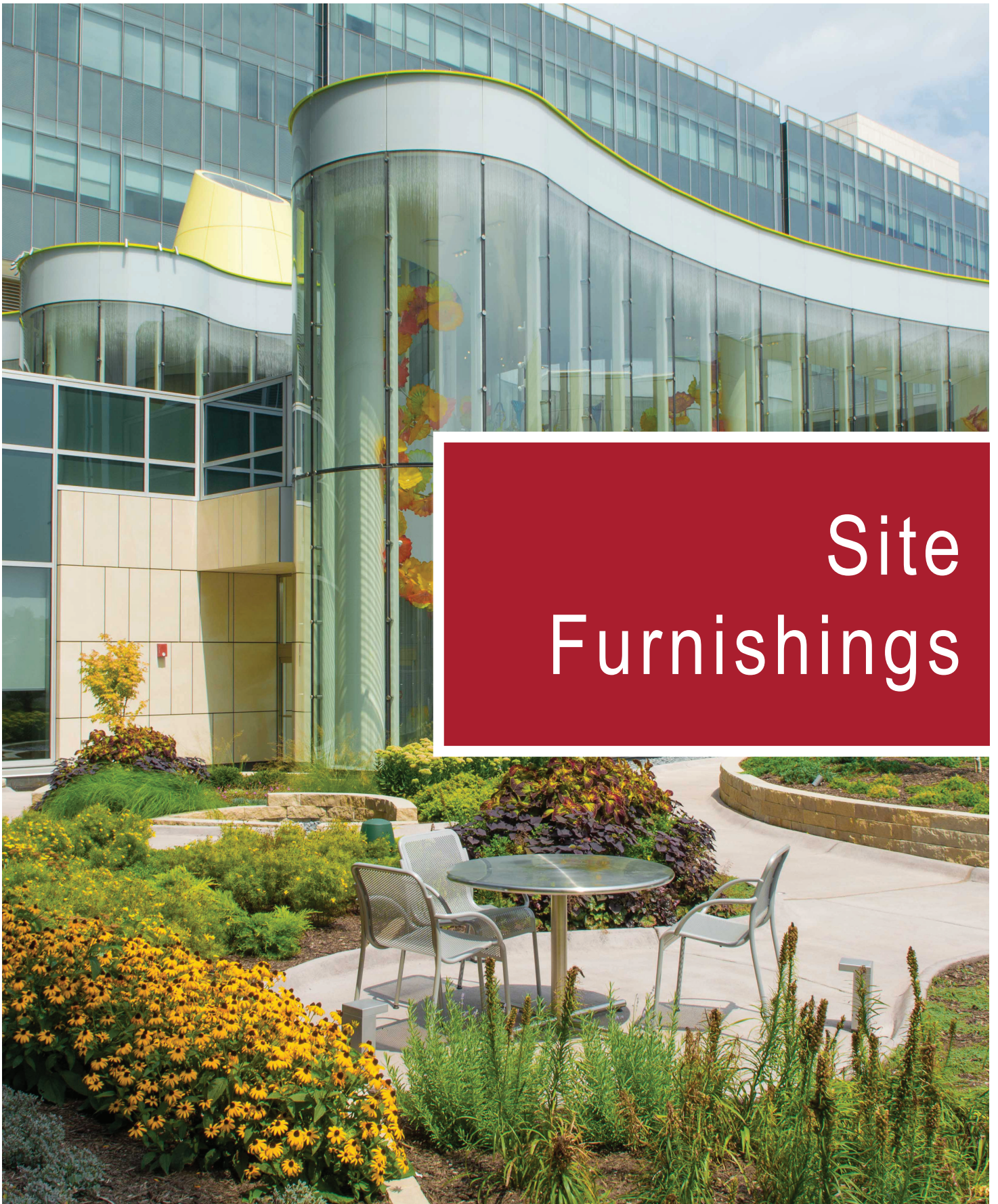

Site Furnishings



Benches - Freestanding

Typical Location: Street Facing, Major Corridors, Bus Stops



Source: Olsson

Presidio

Landscape Forms

Existing Location: NW 42nd & Leavenworth intersection

Seat Style: Backless Straight Bench

Support Style: Surface Mounted

Material: Powdercoated Steel

Primary Color: Obsidian

Secondary Color: Silver

Plexus

Landscape Forms

Existing Location: Truhlsen Entry Plaza

Seat Style: Backed Straight Bench

Support Style: Surface Mounted

Material: Powdercoated Steel

Primary Color: Obsidian

Secondary Color: Silver



Source: Olsson

Benches - Freestanding

Typical Location: Specialty Plaza Spaces

Parameters for Use: Site furnishings with wood slats may only be used when yearly maintenance has been requested and approved. Site furnishings with wood must be placed in a protected location and preferably covered.



Source: Landscape Forms

Strata Beam

Landscape Forms

Seat Style: Backless Straight Bench

Support Style: Freestanding

Leg Material: Natural Meldstone

Seat Material: IPE

Leg Primary Color: Natural Grey

Strata Beam

Landscape Forms

Seat Style: Backed Straight Bench

Support Style: Freestanding

Leg Material: Natural Meldstone

Seat Material: IPE Wood

Leg Primary Color: Natural Grey



Source: Landscape Forms



Benches - Freestanding

Typical Location: Specialty Plaza Spaces



Source: Olsson



Source: Maglin

Ogden Maglin

Existing Location: Munroe-Meyer Institute

Seat Style: Backless Straight Bench

Arm Placement: Sidearm

Support Style: Surface Mounted

Frame Material: Powdercoated Steel

Slat Material: HDPE High Density Polyethylene

Primary Colors: Frame - Red

Slat - Orange Peel Grey

Secondary Colors: Frame - Bronze 14

Slat - Orange Peel Brown

Ogden Maglin

Existing Location: Munroe-Meyer Institute

Seat Style: Backed Straight Bench

Arm Placement: Sidearms

Support Style: Surface Mounted

Frame Material: Powdercoated Steel

Slat Material: HDPE High Density Polyethylene

Primary Colors: Frame - Red

Slat - Orange Peel Grey

Secondary Colors: Frame - Bronze 14

Slat - Orange Peel Brown



Source: Olsson



Source: Maglin

Benches - Freestanding

Typical Location: Specialty Plaza Spaces

Parameter for use: Flor and Vector seating are intended to be used as accent furnishings. It is recommended to use these furnishings are used in restricted manner and alongside more traditional seating types



Source: Olsson



Source: Olsson

Flor

Landscape Forms

Existing Location: Williams Science Hall

Material: Reinforced Casted Stone

Support Style: Freestanding

Primary Color: White

Secondary Color: Grey

Vector

Forms + Surfaces

Existing Location: Storz Pavilion Plaza

Seat Style: Backed and Backless Straight Bench

Support Style: Surface Mounted

Frame & Slat Material: Powdercoated Aluminum

Primary Color: Slate Texture

Secondary Color: Bright Silver Gloss

Note: Frame and slats to match in color



Source: Olsson



Benches - Wall Mounted

Typical Location: Street Facing, Major Corridors, Bus Stops



Source: Landscape Forms

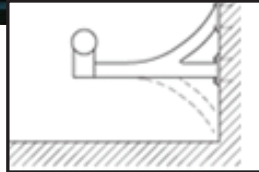

Wall Mount

Plexus

Landscape Forms

Seat Style: Backless Straight Bench

Support Style: Wall Mounted

Materials: Powdercoated Metal

Primary Color: Obsidian

Secondary Color: Silver

Plexus

Landscape Forms

Seat Style: Backed Straight Bench

Support Style: Wall Mounted

Materials: Powdercoated Metal

Primary Color: Obsidian

Secondary Color: Silver



Source: Landscape Forms



Benches - Wall Mounted

Typical Location: Specialty Plaza Spaces



Source: Olsson



Source: Maglin

Ogden Maglin

Existing Location: Munroe-Meyer Institute

Seat Style: Straight Seat Backless

Arm Placement: Sidearms

Support Style: Wall Mounted

Frame Material: Powdercoated Steel

Slat Material: HDPE High Density Polyethylene

Primary Colors: Frame - Red

Slat - Orange Peel Grey

Secondary Colors: Frame - Bronze 14

Slat - Orange Peel Brown

Ogden Maglin

Seat Style: Straight Seat Backed

Arm Placement: Sidearms

Support Style: Wall Mounted

Frame Material: Powdercoated Steel

Slat Material: HDPE High Density Polyethylene

Primary Colors: Frame - Red

Slat - Orange Peel Grey

Secondary Colors: Frame - Bronze 14

Slat - Orange Peel Brown

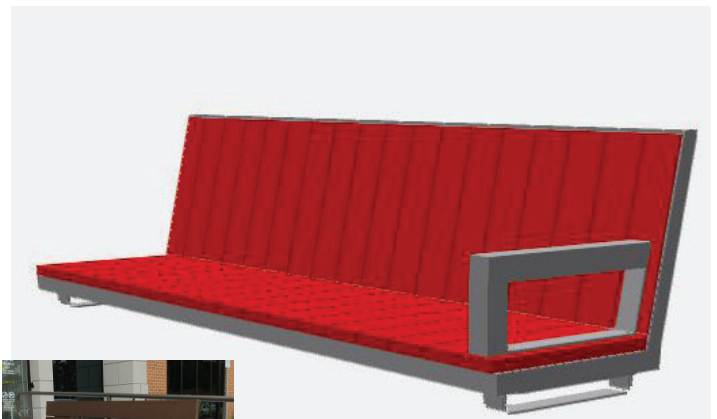

Source: Maglin



Benches - Wall Mounted

Typical Location: Specialty Plaza Spaces, On-Top of Seat Height Site Walls (18-22" height)



Source: Olsson

Wally *Tournesol*

Existing Location: DOC Rooftop Garden

Seat Style: Backless Curved Bench

Support Style: Wall Mounted

Seat Material: Recycled Plastic

Base Material: Powdercoated Steel (Hidden)

Primary Colors: Recycled Dark Brown

Secondary Colors: Recycled Dark Gray

Picnic Table - Independent

Typical Location: Student & Staff Gathering, Dining Areas



Source: Landscape Forms



Harvest

Landscape Forms

Table & Seat Style: Backless Straight Bench & Straight Table

Support Style: Freestanding or Surface Mounted

Material: HDPE Plastic & Powdercoated Aluminum

Notes: Standing height table & benches available, lighting option available

Primary Colors: HDPE - Charcoal Grey
Powdercoated Steel - Dusk

Secondary Color: HDPE - Apple Red
Powdercoated Steel - Apple Red

Ogden Maglin

Existing Location: Munroe-Meyer Institute

Table & Seat Style: Backless Straight Bench & Straight Table

Support Style: Surface Mounted or Freestanding

Frame Material: Powdercoated Metal

Frame Material: Powdercoated Steel

Slat Material: HDPE High Density Polyethylene

Primary Colors: Frame - Red
Slat - Orange Peel Grey

Secondary Colors: Frame - Bronze 14
Slat - Orange Peel Brown



Source: Olsson



Picnic Table - Fixed Chair

Typical Location: Student & Staff Gathering, Dining Areas



Source: Extremis

Virus

Extremis

Seat Style: Backless or Backed Fixed

Seat Number: 3, 4 & 5 Seats available

Support Style: Surface Mounted

Material: Powdercoated Steel

Primary Color: Anthracite

Secondary Color: Bordeaux Red

Notes: Umbrella option available and water drainage holes in table available

Carousel

Landscape Forms

Existing Location: NW Corner of Buffet Cancer Center

Seat Style: Backed, Backless or Hooped

Seat Number: 3, 4, 5, & 6 Seats Available

Support Style: Surface Mounted

Table & Chair Material Options: Powdercoated Heavy Gauge Steel

Primary Color: Obsidian

Secondary Color: Silver

Notes: Standing height and casual height table & benches available, Umbrella option available, 103-187 lbs



Source: Olsson

Picnic Table - Fixed Chair

Typical Location: Student & Staff Gathering, Dining Areas



Source: Olsson

Mingle

Landscape Forms

Existing Location: DOC Rooftop Garden

Seat Style: Backless or Backed Fixed

Table Style: Catena

Seat Number: 2, 3, 4, 5 & 6 Seats available

Support Style: Surface Mounted

Table Material: Powdercoated Heavy Gauge Steel

Chair Material: Powdercoated Aluminum

Primary Colors: Table - Cranberry

Chairs - Silver

Secondary Colors: Silver

Note: DOC Garden has both 4 and 5 configurations,
Umbrella option available, 190 - 220 lbs



Bistro Table & Chairs

Typical Location: Flexible Outdoor Spaces, Student and Staff Gathering
Product selection will be set on a project by project basis.



Source: Landscape Forms

21 Chair

Landscape Forms

Arm Placement: Sidearms

Support Style: Freestanding

Frame Material: Steel tubing

Seat and Back Panels Material: Powdercoated Aluminum

Primary Color: Obsidian

Secondary Color: Cranberry

Note: Chairs stack four high for easy storage

Parc Centre

Landscape Forms

Table Style: 24" or 30" Diameter

Support Style: Surface Mounted

Material: Powdercoated Steel

Primary Color: Obsidian

Secondary Color: Cranberry



Source: Landscape Forms

Bistro Table & Chairs

Typical Location: Flexible Outdoor Spaces, Student and Staff Gathering

Parameters for Use: Site furnishings with wood slats may only be used when yearly maintenance has been requested and approved. Site furnishings with wood must be placed in a protected location and preferably covered.



Source: Landscape Forms



Source: Olsson

Windmark (Table)

Landscape Forms

Existing Location: DOC Rooftop Garden

Support Style: Free Standing

Table top Material: Metal or Wood

Leg Material: Powdercoated Metal

Primary Color: Table Top - IPE

Leg - White

Secondary Color: Table Top - Cranberry

Leg: Silver

Notes: Standing and dinning height table available

Windmark (Chair)

Landscape Forms

Existing Location: DOC Rooftop Garden

Seat Style: Backed Chair

Support Style: Free Standing

Seat Material: Metal or Wood

Leg Material: Powdercoated Metal

Pattern: Rain

Primary Color: Seat - IPE

Leg - White

Secondary Color: Silver

Notes: Standing and dinning height benches available



Source: Landscape Forms

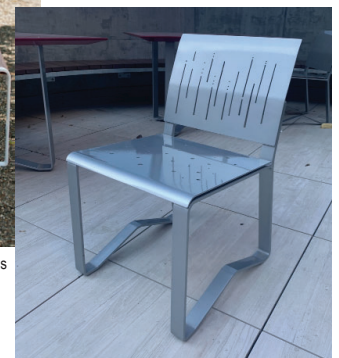

Source: Olsson



Dining Height Table & Chairs

Typical Location: Flexible Outdoor Spaces, Student and Staff Gathering

Parameter for Use: Standing height and bar height tables and chairs are not typical and are to only be used as an additional seating option for outdoor dining and gathering spaces. Primary seating should be table and chairs at dining height.



Source: Olsson

Chipman (Chair)

Landscape Forms

Existing Location: DOC Rooftop Garden

Seat Style: Stool, Bar Height

Material: Powdercoated Aluminum

Support Style: Freestanding

Primary Color: Silver

Secondary Color: Obsidian

Chipman (Table)

Landscape Forms

Existing Location: DOC Rooftop Garden

Table Style: 31" Diameter Standing Height

Material: Powdercoated Cast Aluminum

Support Style: Freestanding

Primary Color: Silver

Secondary Color: Obsidian

Notes: Umbrella option available



Source: Landscape Forms

Bistro Table & Chairs

Typical Location: Flexible Outdoor Spaces, Student and Staff Gathering
Product selection will be set on a project by project basis.



Source: Olsson

Avivo

Forms + Surfaces

Existing Location: Storz plaza

Seat Style: Backed Chairs

Support Style: Freestanding

Chair & Table Material: Powdercoated Aluminum

Primary Color: Slate Texture

Secondary Color: Aluminum Texture

Pattern: Riva Perforation

Notes: Standing and dinning height table & chairs available,
Umbrella option available



Movable Chairs

Typical Location: Flexible Outdoor Spaces, Student and Staff Gathering

Parameters for use: Rocker and lounge chair to be used only in situations where approval has been provided by facilities team. Nearby storage must be provided.



Source: Loll Designs

Lollygagger Rocker

Loll Designs

Seat Style: Backed Rocking Chair

Arm Placement: Sidearms

Material: HDPE Plastic

Weight: 43 lbs

Primary Color: Apple Red

Secondary Color: Charcoal

Lolly Tall Lounge

Loll Designs

Seat Style: Backed Chair

Arm Placement: Sidearms

Material: HDPE Plastic

Weight: 45 lbs

Primary Color: Apple Red

Secondary Color: Charcoal



Source: Loll Designs

Receptacles

Typical Location: Gathering Areas, Project by Project Basis

Note: Place recycle and trash receptacles next to each other at all locations where both are present.

Provide both recycling and trash receptacle when space allows. If constraints exist, only place trash receptacle at a prominent location such as a building main entry/exit.



Source: Olsson



Source: Landscape Forms

Chase Park

Landscape Forms

Existing Location: 42nd and Leavenworth Bus Stop

Material: Powdercoated Steel & Aluminum Slats

Support: Surface Mounted

Signage: Available

Keyed Door Lock: Yes

Primary Color: Obsidian

Secondary Color: Silver

Note: Hinge side door panel for easy emptying, used for recycling & trash

Tonyo

Forms + Surfaces

Internal Frame Material: Stainless Steel

Other material: Powdercoated Aluminum

Support: Surface Mounted

Signage: Available

Keyed Door Lock: No

Primary Color: Aluminum Texture

Secondary Color: Slate Texture

Ash Urn: No

Opening: Sides

Note: Hinge side door panel for easy emptying, used for recycling & trash, 30 or 36 gallon single and split stream available



Source: Forms + Surfaces



Bollards - Security

Typical Location: Pedestrian only campus zones or areas to prevent vehicular access at building entries



Source: Vestre

Urban *Vestre*

Material: Hot Dip Galvanized Powdercoated Steel

Mounting: Removable or Embedded

Primary Color: Traffic Grey A

Secondary Color: Traffic Grey B

Note: Other colors may be chosen on a project by project basis

Charging Stations

Typical Location: Outdoor Seating Location

Parameters for use: Operations and quality of charging stations are to be reviewed on a regular basis by the facilities team. Use only in locations where seating is provided.



Source: Landscape Forms

Outdoor Charging Station

Legrand/Landscape Forms

Material: Powdercoated Aluminum

Pedestal Height: 34"

In-Use Cover: Yes (Vertical Sliding Cover)

Built-in Stabilizer: No (Requires Concrete Base)

Primary Color: Silver

Configuration Options: multiple power modules available, to be determined on a project by project basis



Power Pedestals

Typical Location: Landscape beds on a project by project basis.



Source: Olsson

Gard-N-Post

Arlington Industries

Existing Location:

Material: UV-Rated Plastic

Pedestal Height: 19.5"

In-Use Cover: Yes (Extra-Duty)

Built-in Stabilizer: Yes

Primary Color: Black

Mounting Posts

Focus Industries

Material: Aluminum

Pedestal Height: 26"

In-Use Cover: Yes

Built-in Stabilizer: No

Primary Color: Black



Source: Focus Industries

Visual Bollards

Typical Location: Building entrances that require more visually appealing security bollards.



Source: Olsson



Kornegay Designs Quartz

Landscape Forms

Existing Location: Munroe-Meyer Institute

Material: Concrete

Mounting: Free Standing

Primary Color: Silver Smoke

Secondary Color: Graphite (Iron Oxide)

Note: Custom, to be filled in with concrete

Kornegay Designs Offset

Landscape Forms

Material: Concrete

Mounting: Free Standing

Primary Color: Silver Smoke

Secondary Color: Graphite (Iron Oxide)

Note: Custom, to be filled in with concrete



Source: Landscape Forms



Bike Racks

Typical Location: Building entries and parking lots as needed.



Source: Olsson

A-Frame

Primary Option

Sitescapes

Existing Location: Multiple Locations

Support Style: Embedded or Surface Mounted

Material: 1 1/2" or 2 3/8" Diameter Steel Tubing

Primary Color: Galvanized Stainless Steel

Metro 40

Secondary Option

Landscape Forms

Support Style: Embedded or Surface Mounted

Material: Powdercoated Aluminum

Primary Color: Silver

Secondary Color: Obsidian



Source: Landscape Forms

Bike Repair Stations

Typical Location: Heavy used bicycle areas and bike racks.



Source: Dero



Fixit

Dero

Existing Location: DOC Parking Deck Near Bike Racks

Support Style: Surface Mounted

Material: Powdercoated Metal

Primary Color: Deep Red

Secondary Color: Iron Gray

Tool List:

- Philips and flat head screwdrivers
- 2.5, 3, 4, 5, 6, 8mm Allen wrenches
- 8, 9, 10, 11, 15, 32mm box wrenches
- Tire levers (2)



Planters

Typical Location: Visual bollards at building entries and planting opportunities in hardscape plazas.



Source: Landscape Forms

Paseos

Landscape Forms

Finish: Sandblast

Material: Concrete

Manufacture: Landscape Forms

Primary Color: Silver Smoke

Secondary Color: Ash White

Note: Other colors can be selected on a project by project basis

Highlife III Planters

Streetlife

Material: Wood and Powdercoated Steel

Wood: FSC Hardwood

Primary Color: Traffic Grey A

Secondary Color: Traffic Grey B



Source: Streetlife

Handrails

Typical Location: As Required by ADA.



Source: Olsson

Typical Site Handrails

Existing Location: Munroe-Meyer Institute

Material: Galvanized Stainless Steel

Installation: Embedded

Note: Detailed provided in appendix



Source: Olsson



Railings

Typical Location: As Required by ADA.



Source: Olsson

Typical Site Guard Rail

Existing Location: Storz Pavilion Plaza

Note: Guardrail design and dimensions to match Storz Pavilion Plaza

Typical Site Guard Rail

Existing Location: DOC Rooftop Garden

Note: Guardrail design and dimensions to match DOC Rooftop Garden



Source: Olsson

Fences

Typical Location: Staff patio.



Source: PalmSHIELD

PalmSHIELD

Tiberius Vinyl

Design: Standard rectangular shape

Thickness: 1"

Width: 6" wide planks

Post Spacing: Up to 67" based on standard design

Height: Heights may vary based on design. Standard heights up to 8'.

PalmSHIELD

Charlemagne Perforated

Material: Carbon steel, galvanized steel, aluminum mesh, or stainless steel

Thickness: .032" to .25"

Hole Size: 3/32" to 1"

Width: 48" to 60". Will vary based on infill option

Height: Up to 96". Will vary based on infill option

Post spacing: 48" to 60". Will vary based on infill option.

Hole size: 3/32" to 1"

Height: Up to 96"



Source: PalmSHIELD





Lighting



Pedestrian Lighting

NOTES: Review with UNMC Facilities for color temperature requirements based on each site.

POLE LOCATION REQUIREMENTS:

Notes: Location of pole shall meet the following maximum/minimum placement requirements. Consult UNMC Facilities Management and Planning where deviations are required:

- Minimum 2' offset from back of curb where sidewalk abuts street
- Minimum 4' offset from back of curb where green spaces are present between sidewalk and back of curb to provide adequate room for landscape maintenance
- Maximum 6'-6" from back of curb to provide appropriate lighting levels for pedestrians and streets (regardless of sidewalk location)
- Pedestrian poles are NOT meant to be located within the interior of parking lots. Reference Parking Lot Lighting section for more information.

POLE BASE REQUIREMENTS:

- Concrete pole base elevation shall be 4" above adjacent grade within sidewalks and landscaping
- Concrete pole base diameter shall provide 2" from the base of the shroud to the outside of concrete base (e.g. 16" shroud diameter = 20" pole base diameter)
- Maximum 1" offset from sidewalk when located in green space adjacent to sidewalk to limit vegetation between pole base and sidewalk. Gap shall be filled with expansion joint material between pole base and sidewalk.

POLE REQUIREMENTS:

- Height: 12'

FINISH REQUIREMENTS:

- Dark Green (Smooth Finish) - Hubbell's Finish Code DGN
- Graphite Matte Textured (where approved)

FIXTURE REQUIREMENTS:

- Review with UNMC Facilities for color temperature requirements based on each site
- Review with UNMC Facilities for fixture control requirements based on campus control system and energy code (IECC)

Bounce BNSP2 (LED) *KIM Lighting*

Dark Sky Compliant: Yes (3000k & Warmer)

BUG Rating: B1-U0-G1

Efficacy (CRI): 91-104LPW (70+)

Distribution Patterns: Types II, III, IV, IV (Wide) & V
(Square)



Source: KIM Lighting

Parking Lot Lighting

POLE LOCATION REQUIREMENTS:

Notes: Location of pole shall meet the following maximum/minimum placement requirements. Consult UNMC Facilities Management and Planning where deviations are required:

- Locate lights in landscape islands where possible
- Minimum 1' offset from back of curb where located in landscaping or island
- Where located in parking, align pole with intersection of parking stalls

POLE BASE REQUIREMENTS:

- Concrete pole base diameter shall provide 2" from the base of the shroud to the outside of concrete base (e.g. 16" shroud diameter = 20" pole base diameter)
- Concrete pole base elevation shall be 4" above adjacent grade
- Concrete pole base elevation shall be 2'-6" above adjacent grade

POLE REQUIREMENTS:

- Height: 25

FINISH REQUIREMENTS:

- Silver or Bronze (based on other site furnishings selected, confirm with UNMC PM)

FIXTURE REQUIREMENTS:

- Review with UNMC Facilities for color temperature requirements based on each site
- Review with UNMC Facilities for fixture control requirements based on campus control system and energy code (IECC)

Altitude 2.0 (LED) *KIM Lighting*

Dark Sky Compliant: Yes (3000k & Warmer)

BUG Rating: B2-U0-G3

Efficacy (CRI): 53-135LPW (70+)

Distribution Patterns: Types I, II, III, IV, IV (Wide), V (Wide),
V (Medium), V (Narrow), V (Square), V (Rectangular),
Corner (Left and Right)



Source: KIM Lighting



Bollard Lighting

BOLLARD LOCATION REQUIREMENTS:

Notes: Location of bollard shall meet the following maximum/minimum placement requirements. Consult UNMC Facilities Management and Planning where deviations are required:

- Minimum 4' offset from back of curb where green spaces are present between sidewalk and back of curb to provide adequate room for landscape maintenance

BOLLARD BASE REQUIREMENTS:

- Concrete bollard base shall be flush with adjacent grade when located in pavement
- Concrete bollard base elevation shall be 3" above adjacent grade when located in landscape
- Concrete bollard base diameter shall provide 2" from the base of the bollard to the outside of concrete base (e.g. 16" shroud diameter = 20" concrete pole base diameter)
- Maximum 1" offset from the sidewalk when located in green space adjacent to sidewalk to limit vegetation between bollard base and sidewalk (unless located in landscape bed where further distance from sidewalk is acceptable). Gap shall be filled with expansion joint material between pole base and sidewalk.

BOLLARD REQUIREMENTS:

- Height: 3'-6"

FINISH REQUIREMENTS:

- Dark Green (Smooth Finish) - Hubbell's Finish Code DGN
- Graphite Matte Textured (where approved)

FIXTURE REQUIREMENTS:

- Review with UNMC Facilities for color temperature requirements based on each site
- Review with UNMC Facilities for fixture control requirements based on campus control system and energy code (IECC)



Source: SELUX

Saturn (LED)

Primary Option

SELUX

Dark Sky Compliant: Yes (3000k & Warmer)

BUG Rating: B1-U3-G1

Efficacy (CRI): 83-90LPW (80+)

Distribution Patterns: Types IV & V

System Bollard Head (LED)

Secondary Option

BEGA

Shielded Round or Unshielded

Dark Sky Compliant: Yes (3000k & Warmer)

BUG Rating: B1-U0-G0

Efficacy (CRI): 48-65LPW (80+)

Distribution Patterns: Types V

Note: Can be configured with outlet, light head, flood light, or capped top for security bollard without lighting



Source: BEGA

Step Lighting

STEP LIGHT LOCATION REQUIREMENTS:

Notes: Review with UNMC Facilities Management and Planning for locations of intended use and height above pavement.



Source: Cole Lighting

L500 Series

COLE Lighting

Dark Sky Compliant: No

BUG Rating: B0-U1-G0

Efficacy (CRI): 84-104LPW (80+)

Distribution Patterns: Asymmetric Forward Throw

Finish: Silver

Housing / Faceplate: Galvanized Steel (Powder Coated) / Aluminum

Depth: 6"



Up-Lighting

UP-LIGHT LOCATION REQUIREMENTS:

Notes: Review with UNMC Facilities Management and Planning for locations of intended use and setback from surface to be illuminated.



Source: Olsson

Lumenbeam Inground

Primary Option

LumenPulse

Existing Location: 42nd & Leavenworth Kaneko Garden

Dark Sky Compliant: No

Direct View: Yes

Drive Over Capable: Yes (11,000lbs)

Adjustable Tilt / Aim: Yes / Yes

Efficacy (CRI): 53-82LPW (80+)

Distribution Patterns: Symmetric (x5), Bi-Symmetric-Horizontal (x4), Bi-Symmetric-Vertical (x4), Asymmetric (x2)

Finish: Silver

Diameter / Depth: 10" / 12 1/2"

Housing / Trim: Fiberglass Reinforced Polymer / Stainless Steel

- Include drainage material around housing per manufacturer's installation requirements, where installed in concrete a weep rope to be provided for adequate moisture drainage
- Factory sealed optical chamber required to prevent ingress of moisture on the lens

KIOS

Secondary Option

Ligman Lighting USA

Dark Sky Compliant: No

Direct View: Yes

Drive Over Capable: Yes (11,000lbs)

Adjustable Tilt / Aim: Yes / Yes

Efficacy (CRI): 45-110LPW (80+)

Distribution Patterns: Symmetric (x4), Bi-Symmetric-Horizontal (x2), Bi-Symmetric-Vertical (x3), Asymmetric (x2)

Finish: Silver

Diameter/Depth: 11.2" / 6"

Housing / Trim: Die-Cast Aluminum (Marine Grade) / Stainless Steel



Source: Ligman Lighting USA

Wall Lighting





WALL LIGHT LOCATION REQUIREMENTS:

Notes: Review with UNMC Facilities Management and Planning for locations of intended use, height, and placement of building facade. Review with UNMC Facilities for color temperature requirements based on each site.

Wall Luminaires

Primary Options

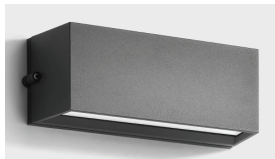
BEGA

			
22 2(15,61)	24 37 (2,4,3)	22 360 / 22 365	33 51(3,4)
Dark Sky Compliant: Yes	Yes	Yes / No	Yes
BUG Rating: B0-U0-G0	B1-U0-G0	B1-U0-G0 / B1-U4-G0	B0-U0-G0
Efficacy (CRI) 82-86LPW (90)	75-98LPW (80)	66-84LPW (80) / 91-107LPW (80)	68-75LPW (80)
Finish: Silver	Silver	Silver	Silver
Housing: Die-Cast Aluminum	Die-Cast Aluminum	Die-Cast Aluminum	Die-Cast Aluminum
Depth: 2-3/8"	3-3/8" - 4"	4"	2-3/8"

WDGE1 (LED)

Secondary Option

Lithonia

Existing Location: Truhlsen Eye Institute
 Dark Sky Compliant: Yes (Nighttime Friendly)
 BUG Rating: B1-U0-G0
 Efficacy (CRI): 112-133LPW (80+)
 Distribution Patterns: Forward, Wide
 Finish: Silver
 Housing: Die-Cast Aluminum
 Depth: 5-1/2"



Source: Lithonia Lighting



Signage Lighting

SIGNAGE LIGHTING LOCATION REQUIREMENTS:

Notes: Coordinate internally illuminated signage and externally illuminated signage requirements with UNMC Facilities Management and Planning. Location of lights shall be based on vertical surface area to be illuminated, coordinate locations with UNMC Facilities Management and Planning. Locate within landscape when possible. Where located within landscaping, ensure fixture and base do not obscure landscape material or create maintenance issues.

SIGNAGE POLE BASE REQUIREMENTS:

- Concrete flood light base diameter shall be 10"
- Concrete flood light base elevation shall be 2" above adjacent grade

Small Scale Flood Light *BEGA*

Existing Location: 42nd & Leavenworth Monument Sign

DarkSky Compliant: No

Glare Control: Yes

Adjustable Tilt / Aim: Yes / Yes

Efficacy (CRI): 75-137LPW (80+)

Finish: Bronze

Housing / Trim: Die-Cast Aluminum



Source: Olsson

Appendix

Handrails

Details

Project: Munroe-Meyer Institute

